



# Gatwick Airport Northern Runway Project

Environmental Statement

Appendix 5.3.2: Code of Construction Practice Annex 6 – Outline Arboricultural and Vegetation Method Statement – Part 2 – Clean Version

**Book 5**

VERSION: 3.0

DATE: JUNE 2024

Application Document Ref: 5.3

PINS Reference Number: TR020005

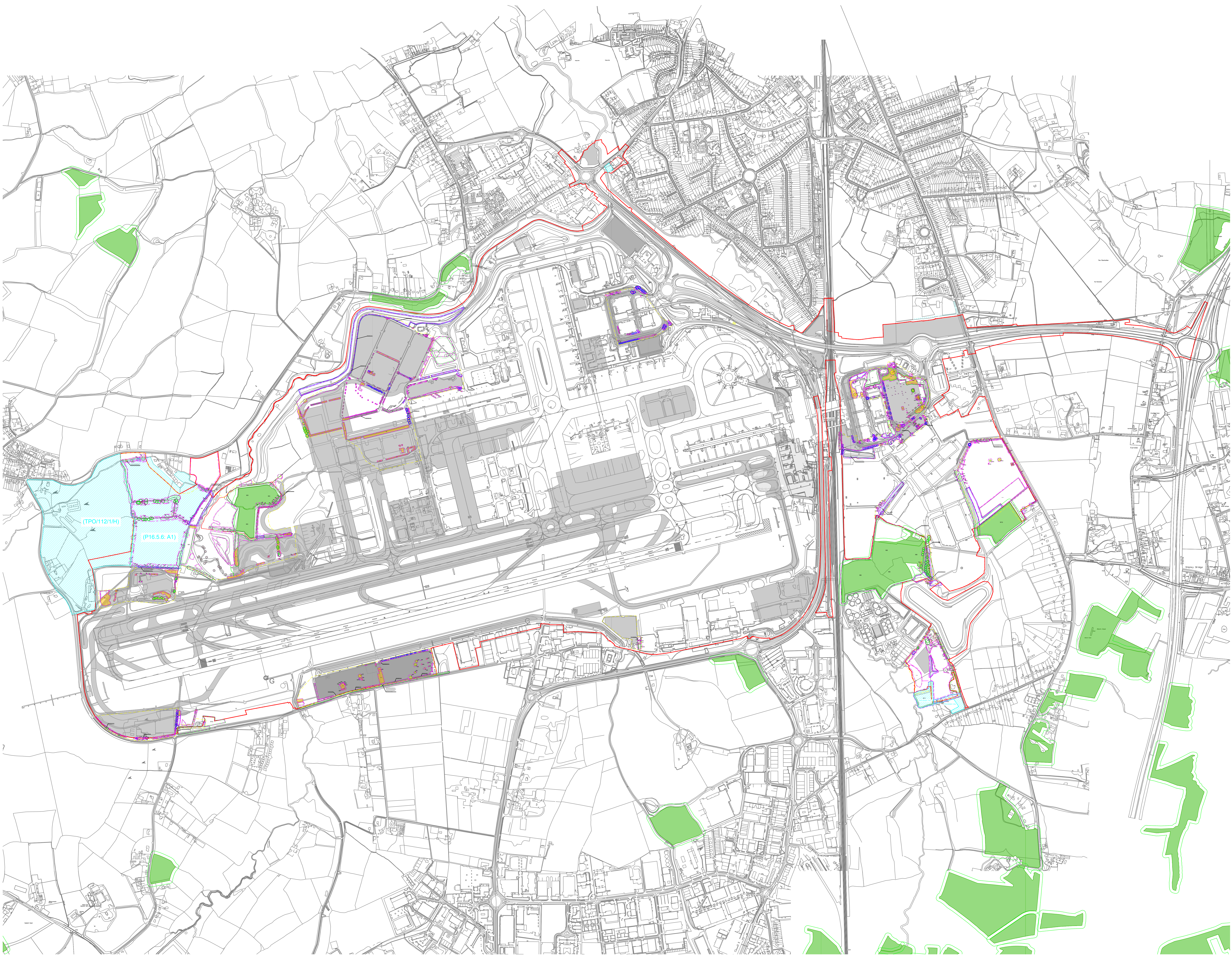

### Key

- Site boundary.
- Survey boundary.
- Tree with numbered reference. Canopy spread and coloured BS5837:2012 tree quality category as shown below. # = Tree details estimate (inaccessible tree) = Tree in off site location.
- Tree group plotted with individual stem locations and numbered reference. Canopy extents coloured to match BS5837:2012 tree quality category as shown below.
- Tree or Vegetation group with numbered reference. Canopy extents coloured to match BS5837:2012 tree quality category as shown below and dashed line to show indicative stem line.
- Hedge with numbered reference. Canopy extents and coloured BS5837:2012 tree quality category as shown below and dashed line to show hedge centreline.
- Woodland with numbered reference. Canopy extents coloured to match BS5837:2012 tree quality category as shown below and dashed line to show indicative tree line.

**BS 5837:2012 Tree Quality Categories - Table 1**

- Category A - High quality
- Category B - Moderate quality
- Category C - Low quality
- Category U - Unsuitable for retention

Direction of first significant branch

- Root protection area (RPA) Calculated in accordance with Section 4.6 - BS5837:2012
- Veteran tree buffer (15 x stem Ø) (as per standing advice produced by Forestry England and Natural England)
- Tree protected by Tree Preservation Order. Bracketted number relates to the TPO reference.
- Designated Ancient Woodland (as per Natural England ancient woodland inventory, via open data publication)
- Ancient Woodland tree buffer (15m offset) (as per standing advice produced by Forestry England and Natural England)
- Projected tree loss required for construction of the Project (worst case scenario)
- Indicative Scheme Layout
- Indicative temporary protective fence/line in accordance with Section 6.2 - BS5837:2012. See below for example barriers.
- Indicative secondary protective Hi-Vis Mesh fence/line in accordance with Section 6.2 - BS5837:2012. See below for example barriers.
- Indicative vegetation protective fence/line. Design and location to be agreed by local council during detail design.

**NOTES:**

- Refer to ES Appendix 6.10.1. Tree Survey Report and Arboricultural Impact Assessment for further details.
- Survey based on a visual inspection from the ground and is not intended as a full arboricultural inspection.
- Plan produced in accordance with recommendations set out in BS 5837:2012. "Tasks in Relation to design, demolition and construction".
- Survey based upon Aerial Photography and trees located by eye.

©Master\TEMPLATE\ES\AVMS\CAD\Fig2.jpg

©Master\TEMPLATE\ES\AVMS\CAD\Fig3.jpg

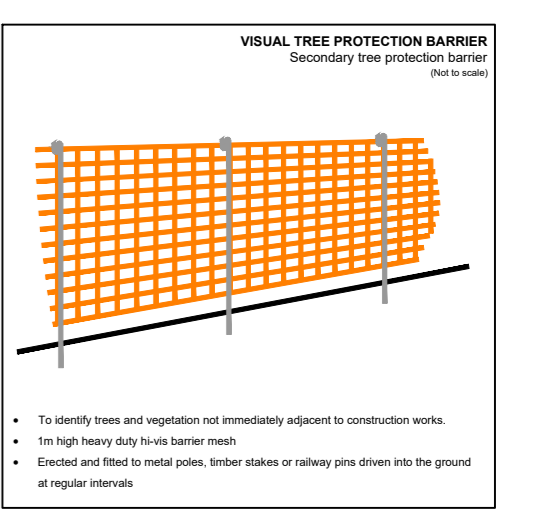

**DOCUMENT**

**Environmental Statement**

DRAWING TITLE  
**Airport Preliminary Tree Removal & Protection Plans**  
 Appendix 5.3.2 Annex 6  
 Overview

DATE  
**June 2024**

ORIENTATION N	DRAWING NO. 735	REVISION For ES Issue
	DRAWN BY RC	PM / CHECKED BY DC

SCALE @ A0  
**Custom Scale**

Reproduced from Ordnance Survey map with the permission of Ordnance Survey on behalf of the controller of Her Majesty's Stationery Office © Crown Copyright (2023). License number 010031673, 10004892.  
 © Copyright 2023 Gatwick Airport Limited. No part of this drawing is to be reproduced without prior permission of Gatwick Airport Limited.

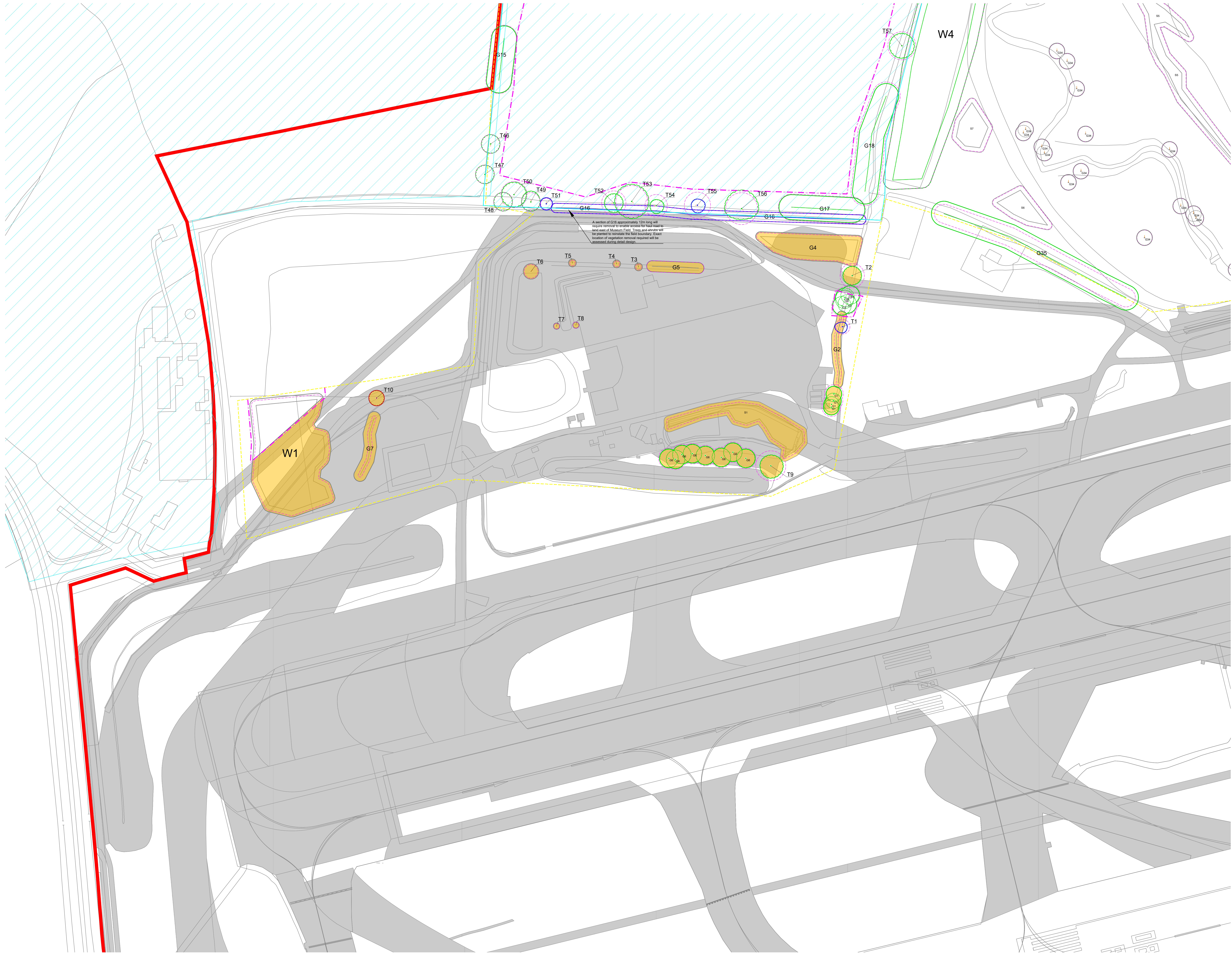

- Key**
- Site boundary
  - Survey boundary
  - Tree with numbered reference. Canopy extent and colour to match BS5837:2012 tree quality category as shown below.
    - = Tree details estimate (non-possible tree)
    - = Tree in situ location
  - Tree group plotted with individual stem locations and numbered reference. Canopy extent colour to match BS5837:2012 tree quality category as shown below
  - Tree or Vegetation group with numbered reference. Canopy extent colour to match BS5837:2012 tree quality category as shown below and dashed line to show indicative stem line.
  - Hedge with numbered reference. Canopy extent and colour to match BS5837:2012 tree quality category as shown below and dashed line to show hedge centreline.
  - Woodland with numbered reference. Canopy extent colour to match BS5837:2012 tree quality category as shown below and dashed line to show indicative line.
- BS 5837:2012 Tree Quality Categories - Table 1
- Category A - High quality
  - Category B - Moderate quality
  - Category C - Low quality
  - Category U - Unsuitable for retention
- Direction of first significant branch
  - Root protection area (RPA). Calculated in accordance with Section 4.6 - BS5837:2012
  - Vegetation tree buffer (15 x stem Ø) (as per standing advice produced by Forestry England and Natural England)
  - Tree protected by Tree Preservation Order. Bracketed number relates to the TPO reference.
  - Designated Ancient Woodland (as per Natural England ancient woodland inventory, via open data publication)
  - Ancient Woodland tree buffer (15m offset) (as per standing advice produced by Forestry England and Natural England)
  - Projected tree loss required for construction of the Project (best case scenario)
  - Indicative Scheme Layout
  - Indicative temporary protective fence line in accordance with Section 6.2 - BS5837:2012. See below for example barriers.
  - Indicative secondary protective H/Vs Mesh fence line in accordance with Section 6.2 - BS5837:2012. See below for example barriers.
  - Indicative vegetation protective fence line; Design and location to be agreed by local council during detail design.

**NOTES:**

- Refer to ES Appendix 6.10.1: Tree Survey Report and Arboricultural Survey on behalf of the controller of Her Majesty's Stationery Office
- Some elements of this report are not intended for use as a full arboricultural report.
- The content is for information only and does not constitute a contract.
- Some trees are shown in red in this drawing and are to be removed.
- Some trees are shown in green in this drawing and are to be retained.

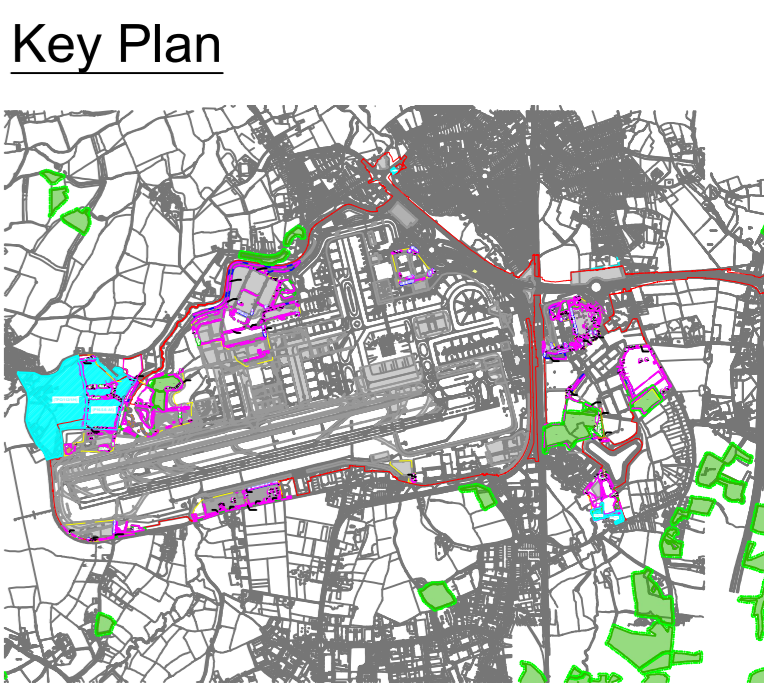
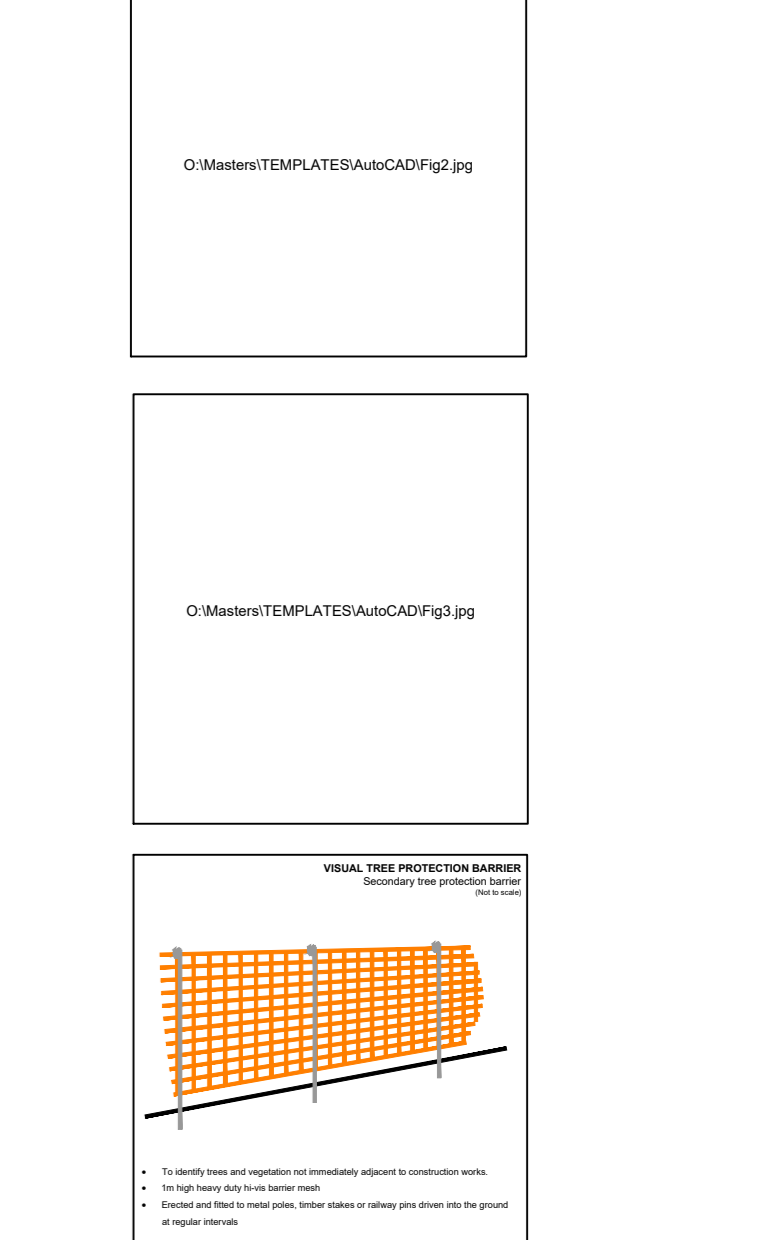

**Environmental Statement**

DRAWING TITLE  
**Airport Preliminary Tree Removal & Protection Plans**  
 Appendix 5.3.2 Annex 6  
 Sheet 1 of 13

DATE  
 June 2024

ORIENTATION	DRAWING NO.	REVISION
N	750	For ES Issue
	DRAWN BY	PM / CHECKED BY
	RC	DC

SCALE @ A0  
 0m 25m 50m



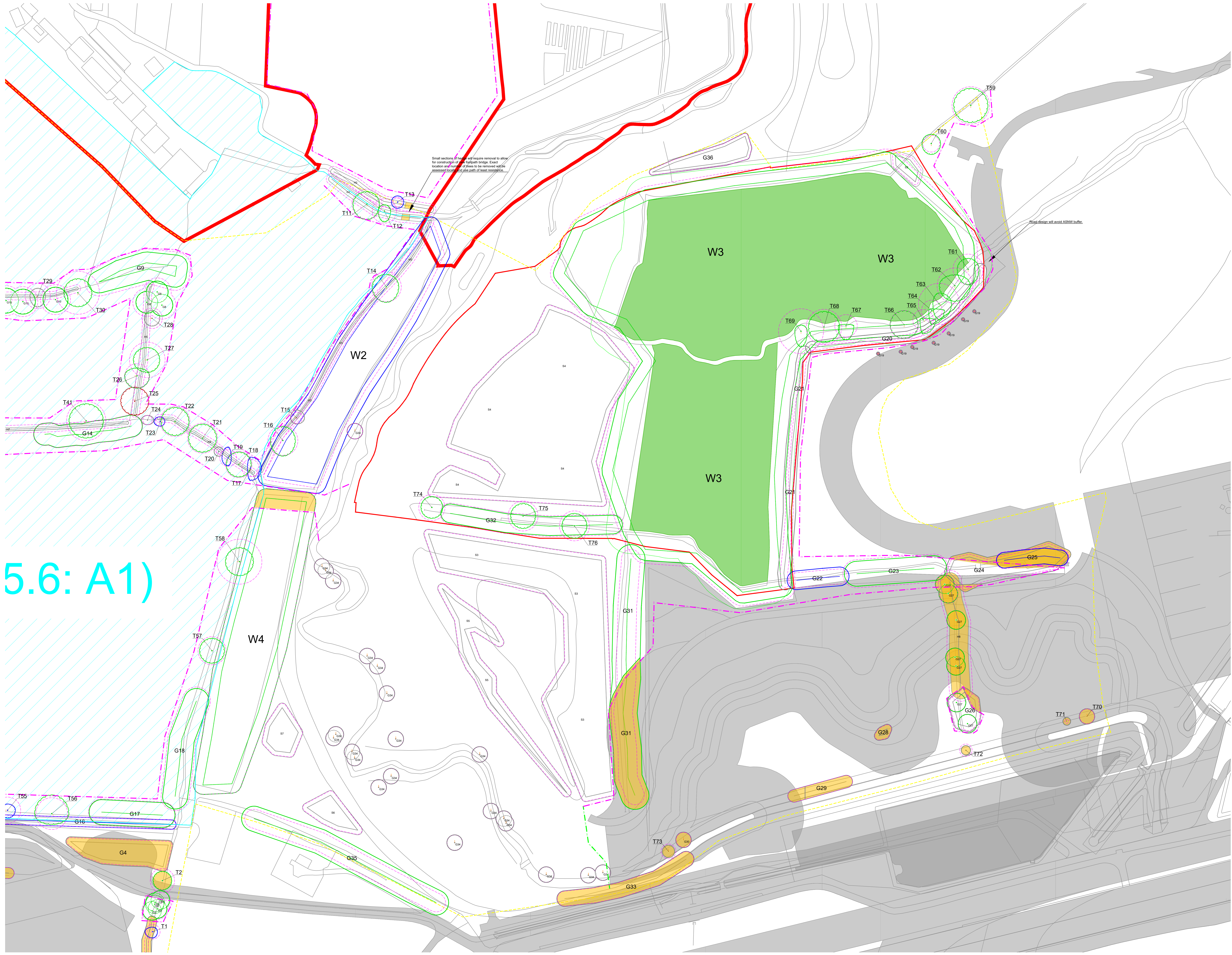

5.6: A1)

- Key**
- Site boundary
  - Survey boundary
  - Tree with numbered reference. Canopy spread and coloured BS5837:2012 tree quality category as shown below.
    - = Tree details estimate (reasonable tree)
    - = Tree in off site location
  - Tree group plotted with individual stem locations and numbered reference. Canopy extents coloured to match BS5837:2012 tree quality category as shown below.
  - Tree or Vegetation group with numbered reference. Canopy extents coloured to match BS5837:2012 tree quality category as shown below and dashed line to show indicative stem line.
  - Hedge with numbered reference. Canopy extents and coloured BS5837:2012 tree quality category as shown below and dashed line to show hedge centreline.
  - Woodland with numbered reference. Canopy extents coloured to match BS5837:2012 tree quality category as shown below and dashed line to show indicative tree line.
- BS 5837:2012 Tree Quality Categories - Table 1
- Category A - High quality
  - Category B - Moderate quality
  - Category C - Low quality
  - Category U - Unsuitable for retention
- Direction of first significant branch
  - Road protection area (RPA) Calculated in accordance with Section 4.6 - BS5837:2012
  - Veteran tree buffer (15 x stem Ø) (as per standing advice produced by Forestry England and Natural England)
  - Tree protected by Tree Preservation Order. Bracketed number relates to the TPO reference.
  - Designated Ancient Woodland (as per Natural England ancient woodland inventory, via open data publication)
  - Ancient Woodland tree buffer (15m offset) (as per standing advice produced by Forestry England and Natural England)
  - Projected tree loss required for construction of the Project (best case scenario)
  - Indicative Scheme Layout
  - Indicative temporary protective fence line in accordance with Section 6.2 - BS5837:2012. See below for example barriers.
  - Indicative secondary protective H/Vs Mesh fence line in accordance with Section 6.2 - BS5837:2012. See below for example barriers.
  - Indicative vegetation protective fence line; Design and location to be agreed by local council during detail design.

**NOTES:**

- Refer to ES Appendix 6.10.1: Tree Survey Report and Arboricultural Survey on behalf of the controller of Her Majesty's Stationery Office © Crown Copyright (2023). License number 6100031673, 10001998, 100048492.
- The information shown on this drawing is for information only and is not intended as a final arboricultural report.
- The information shown on this drawing is for information only and is not intended as a final arboricultural report.
- BS5837:2012 - "Trees in Relation to Design, Demolition and Construction"
- Some trees shown are photographs and trees located by eye.

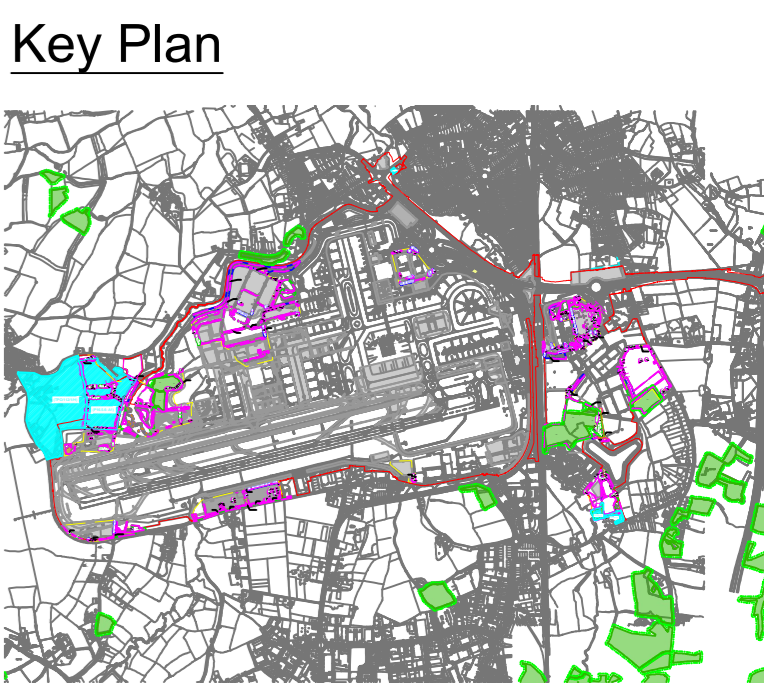

DOCUMENT  
**Environmental Statement**

DRAWING TITLE  
**Airport Preliminary Tree Removal & Protection Plans Appendix 5.3.2 Annex 6 Sheet 3 of 13**

DATE	June 2024	
ORIENTATION	DRAWING NO.	REVISION
N	752	For ES Issue
	DRAWN BY	PM / CHECKED BY
	RC	DC

SCALE @ A0  
0m 25m 50m

Reproduced from Ordnance Survey map with the permission of Ordnance Survey on behalf of the controller of Her Majesty's Stationery Office © Crown Copyright (2023). License number 6100031673, 10001998, 100048492.  
© Copyright 2023 Gatwick Airport Limited. No part of this drawing is to be reproduced without prior permission of Gatwick Airport Limited.

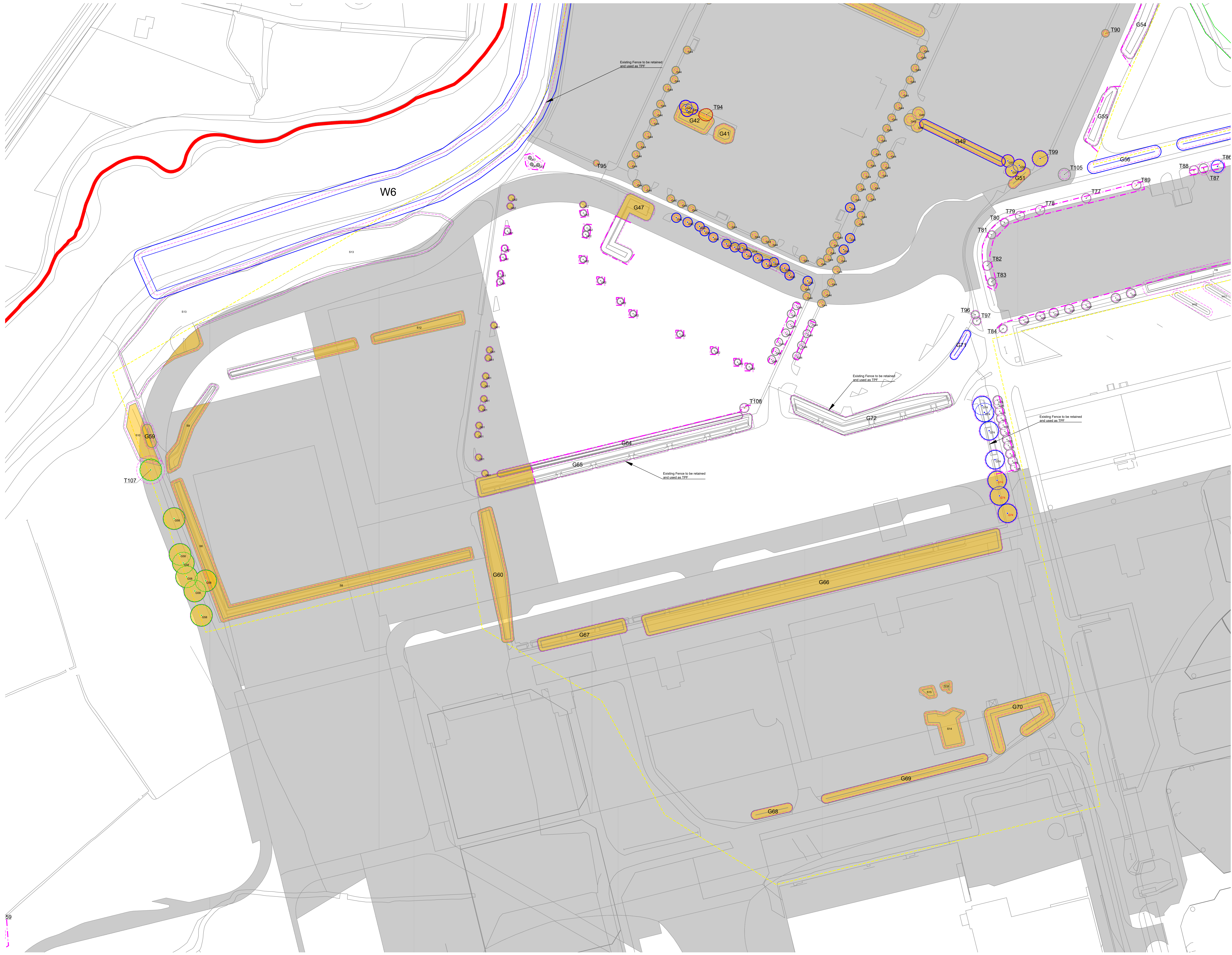

### Key

- Site boundary
- Survey boundary
- Tree with numbered reference. Canopy spread and coloured BSS537 2012 tree quality category as shown below.
  - = Tree details estimate (non-possible tree)
  - = Tree in off site location
- Tree group plotted with individual stem locations and numbered reference. Canopy extents coloured to match BSS537 2012 tree quality category as shown below
- Tree or Vegetation group with numbered reference. Canopy extents coloured to match BSS537 2012 tree quality category as shown below and dashed line to show indicative stem line.
- Hedge with numbered reference. Canopy extents and coloured BSS537 2012 tree quality category as shown below and dashed line to show hedge centreline.
- Woodland with numbered reference. Canopy extents coloured to match BSS537 2012 tree quality category as shown below and dashed line to show indicative line.

BSS537 2012 Tree Quality Categories - Table 1

- Category A - High quality
- Category B - Moderate quality
- Category C - Low quality
- Category U - Unsuitable for retention

- Direction of first significant branch
- Road protection area (RPA). Calculated in accordance with Section 4.6.
- BSS537 2012
- Veteran tree buffer (15 x stem Ø) (as per standing advice produced by Forestry England and Natural England)
- Tree protected by Tree Preservation Order. Bracketed number relates to the TPO reference.
- Designated Ancient Woodland (as per Natural England ancient woodland inventory, via open data publication)
- Ancient Woodland tree buffer (15m offset) (as per standing advice produced by Forestry England and Natural England)
- Projected tree loss required for construction of the Project (best case scenario)
- Indicative Scheme Layout
- Indicative temporary protective fence line in accordance with Section 6.2 - BSS537 2012. See below for sample barrier.
- Indicative secondary protective H/Vs Mesh fence line in accordance with Section 6.2 - BSS537 2012. See below for sample barriers.
- Indicative vegetation protective fence line. Design and location to be agreed by local council during detail design.

NOTES:

- Refer to ES Appendix 6.10.1: Tree Survey Report and Arboricultural
- Some assessments for further details.
- Plan produced in accordance with recommendations set out in BSS537 2012 - "Trees in Relation to Design, Demolition and Construction"
- Some trees are not shown in this plan and are located to the west of the site.

### Key Plan

DOCUMENT

**Environmental Statement**

DRAWING TITLE  
**Airport Preliminary Tree Removal & Protection Plans**  
 Appendix 5.3.2 Annex 6  
 Sheet 4 of 13

DATE  
**June 2024**

ORIENTATION	DRAWING NO.	REVISION
N	753	For ES Issue
	DRAWN BY	PM / CHECKED BY
	RC	DC

SCALE @ A0  
 0m 25m 50m

Reproduced from Ordnance Survey map with the permission of Ordnance Survey on behalf of the controller of Her Majesty's Stationery Office © Crown Copyright (2023). License number 6100031673, 100048492.  
 © Copyright 2023 Gatwick Airport Limited. No part of this drawing is to be reproduced without prior permission of Gatwick Airport Limited.



**Key**

- Site boundary
- Survey boundary
- Tree with numbered reference. Canopy spread and colour to match BS5837:2012 tree quality category as shown below.
  - = Tree details estimate (non-possible tree)
  - = Tree in off site location
- Tree group plotted with individual stem locations and numbered reference. Canopy extent to match BS5837:2012 tree quality category as shown below
- Tree or Vegetation group with numbered reference. Canopy extent to match BS5837:2012 tree quality category as shown below and dashed line to show indicative stem line.
- Hedge with numbered reference. Canopy extent to match BS5837:2012 tree quality category as shown below and dashed line to show hedge centreline.
- Woodland with numbered reference. Canopy extent to match BS5837:2012 tree quality category as shown below and dashed line to show indicative tree line.

BS 5837:2012 Tree Quality Categories - Table 1

- Category A - High quality
- Category B - Moderate quality
- Category C - Low quality
- Category U - Unsuitable for retention

- Direction of first significant branch
- Root protection area (RPA). Calculated in accordance with Section 4.6. BS5837:2012
- Veteran tree buffer (15 x stem Ø) (as per standing advice produced by Forestry England and Natural England)
- Tree protected by Tree Preservation Order. Bracketted number relates to the TPO reference.
- Designated Ancient Woodland (as per Natural England ancient woodland inventory, via open data publication)
- Ancient Woodland tree buffer (15m offset) (as per standing advice produced by Forestry England and Natural England)
- Projected tree loss required for construction of the Project (best case scenario)
- Indicative Scheme Layout
- Indicative temporary protective fence line in accordance with Section 6.2 - BS5837:2012. See below for sample format.
- Indicative secondary protective H/V Mesh fence line in accordance with Section 6.2 - BS5837:2012. See below for sample format.
- Indicative vegetation protective fence line. Design and location to be agreed by local council during detail design.

- NOTES:**
- Refer to ES Appendix 6.10.1: Tree Survey Report and Arboricultural
  - Some areas are not visible from the ground and are not intended as a full arboricultural inspection.
  - The work is in accordance with recommendations set out in BS 5837:2012 - "Trees in Relation to Design, Demolition and Construction".
  - Some trees are not shown in this drawing as they are not visible to eye.

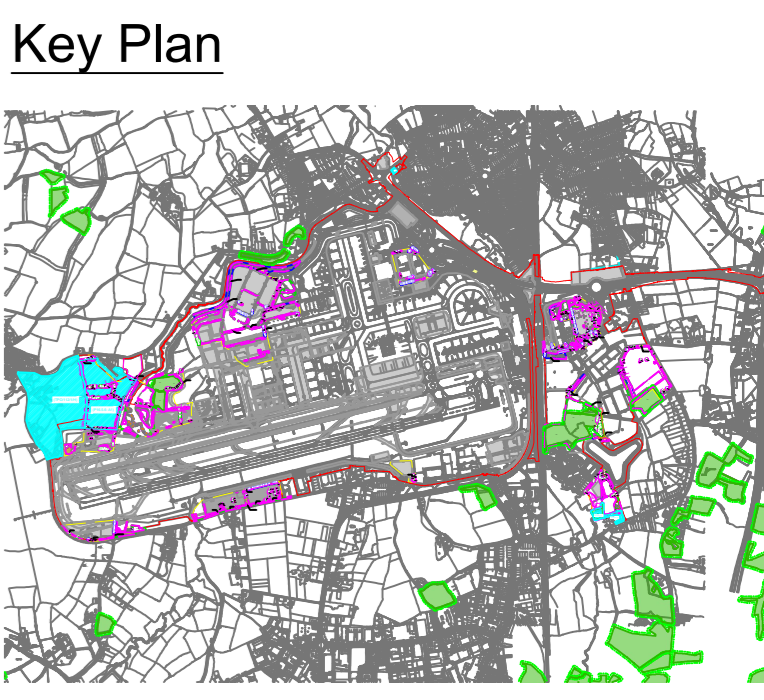

DOCUMENT

**Environmental Statement**

DRAWING TITLE

**Airport Preliminary Tree Removal & Protection Plans Appendix 5.3.2 Annex 6 Sheet 5 of 13**

DATE

**June 2024**

ORIENTATION	DRAWING NO.	REVISION
N	754	For ES Issue
	DRAWN BY	PM / CHECKED BY
	RC	DC

SCALE @ A0

0m 25m 50m

Reproduced from Ordnance Survey map with the permission of Ordnance Survey on behalf of the controller of Her Majesty's Stationery Office © Crown Copyright (2023). License number 0100031673, 100048492. © Copyright 2023 Gatwick Airport Limited. No part of this drawing is to be reproduced without prior permission of Gatwick Airport Limited.

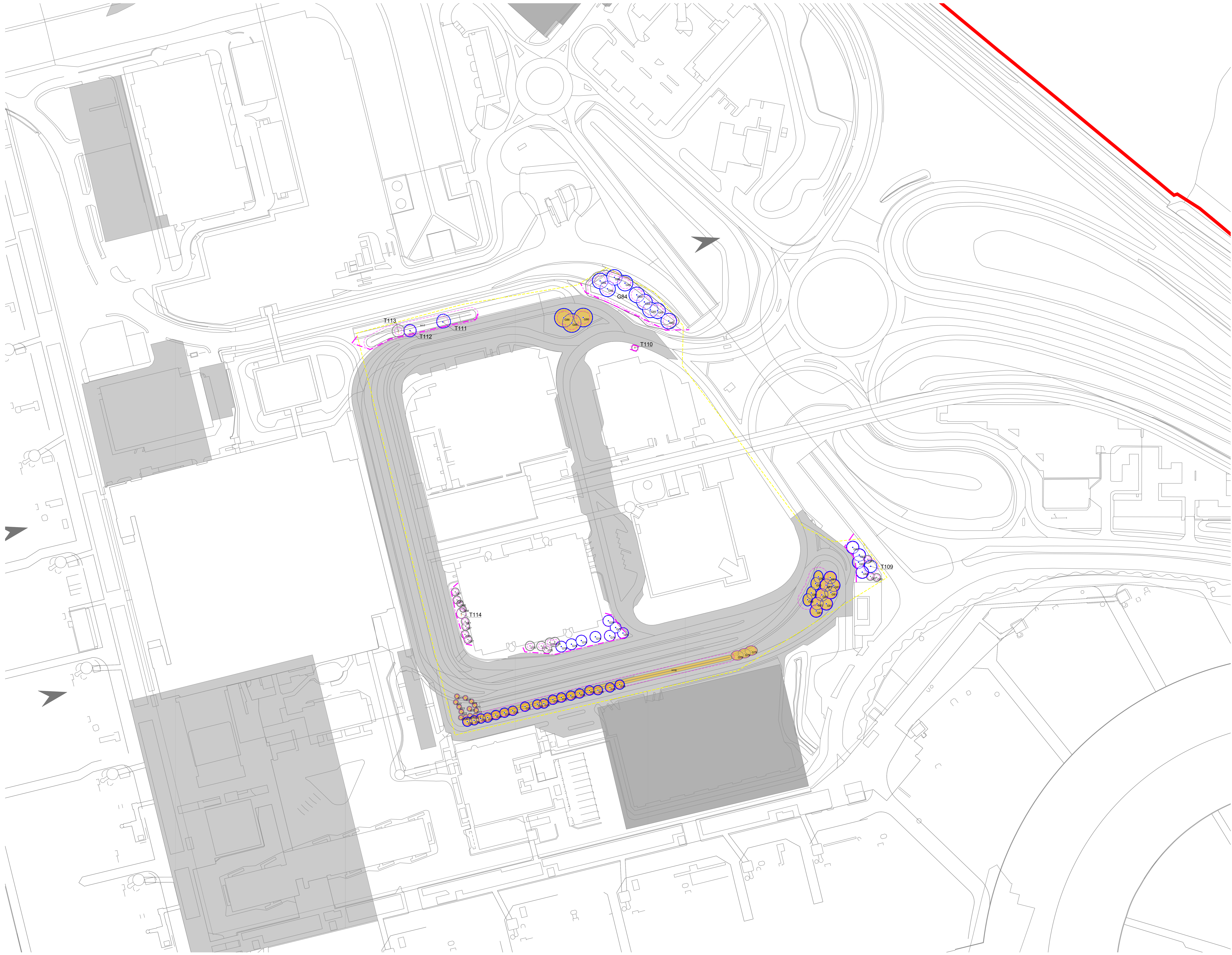

- Key**
- Site boundary
  - Survey boundary
  - Tree with numbered reference. Canopy extent and colour BS5837:2012 tree quality category as shown below.
    - = Tree details estimate (possible tree)
    - = Tree in off site location
  - Tree group plotted with individual stem locations and numbered reference. Canopy extents coloured to match BS5837:2012 tree quality category as shown below
  - Tree or Vegetation group with numbered reference. Canopy extents coloured to match BS5837:2012 tree quality category as shown below and dashed line to show indicative stem line.
  - Hedge with numbered reference. Canopy extents coloured BS5837:2012 tree quality category as shown below and dashed line to show hedge centreline.
  - Woodland with numbered reference. Canopy extents coloured to match BS5837:2012 tree quality category as shown below and dashed line to show indicative tree line.
- BS 5837:2012 Tree Quality Categories - Table 1
- Category A - High quality
  - Category B - Moderate quality
  - Category C - Low quality
  - Category U - Unsuitable for retention
- Direction of first significant branch
  - Flood protection area (FPA) Calculated in accordance with Section 4.6 - BS5837:2012
  - Veteran tree buffer (15 x stem Ø) (as per standing advice produced by Forestry England and Natural England)
  - Tree protected by Tree Preservation Order. Bracketted number relates to the TPO reference.
  - Designated Ancient Woodland (as per Natural England ancient woodland inventory, via open data publication)
  - Ancient Woodland tree buffer (15m offset) (as per standing advice produced by Forestry England and Natural England)
  - Projected tree loss required for construction of the Project (worst case scenario)
  - Indicative Scheme Layout
  - Indicative temporary protective fence/line in accordance with Section 6.2 - BS5837:2012. See below for example barriers.
  - Indicative secondary protective H/Vs Mesh fence/line in accordance with Section 6.2 - BS5837:2012. See below for example barriers.
  - Indicative vegetation protective fence/line; Design and location to be agreed by local council during detail design.

**NOTES:**

- Refer to ES Appendix 6.10.1: Tree Survey Report and Arboricultural Survey on behalf of the controller of Her Majesty's Stationery Office © Crown Copyright (2023). License number 0100031673, 100048492, 100048492.
- The information is provided as a guide only and is not intended to be used as a basis for any legal proceedings.
- Some trees may be protected by Tree Preservation Orders (TPOs) or other legal restrictions.
- Some trees may be protected by Tree Preservation Orders (TPOs) or other legal restrictions.

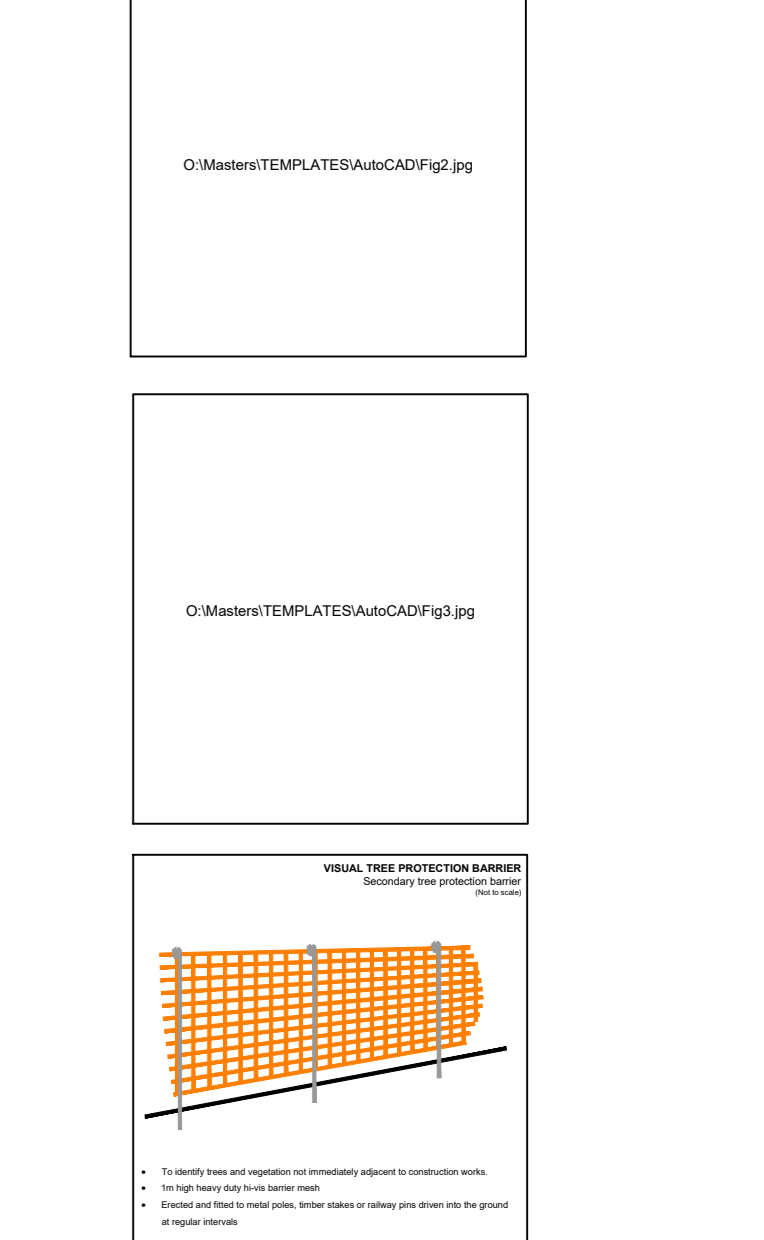

**Key Plan**

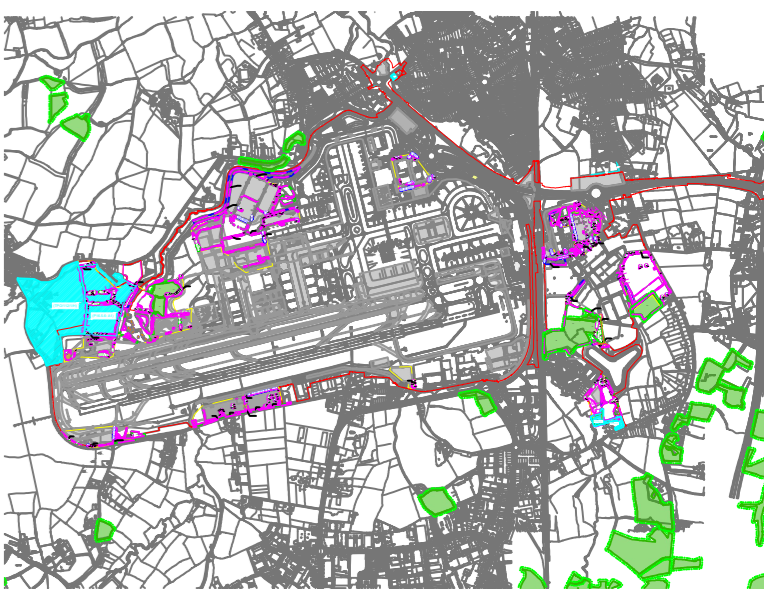

**DOCUMENT**

**Environmental Statement**

**DRAWING TITLE**

**Airport Preliminary Tree Removal & Protection Plans Appendix 5.3.2 Annex 6 Sheet 6 of 13**

**DATE**

**June 2024**

<b>ORIENTATION</b>	<b>DRAWING NO.</b>	<b>REVISION</b>
	755	For ES Issue
	<b>DRAWN BY</b>	<b>PM / CHECKED BY</b>
	RC	DC

**SCALE @ A0**

0m 25m 50m

Reproduced from Ordnance Survey map with the permission of Ordnance Survey on behalf of the controller of Her Majesty's Stationery Office © Crown Copyright (2023). License number 0100031673, 100048492, 100048492.

© Copyright 2023 Gatwick Airport Limited. No part of this drawing is to be reproduced without prior permission of Gatwick Airport Limited.





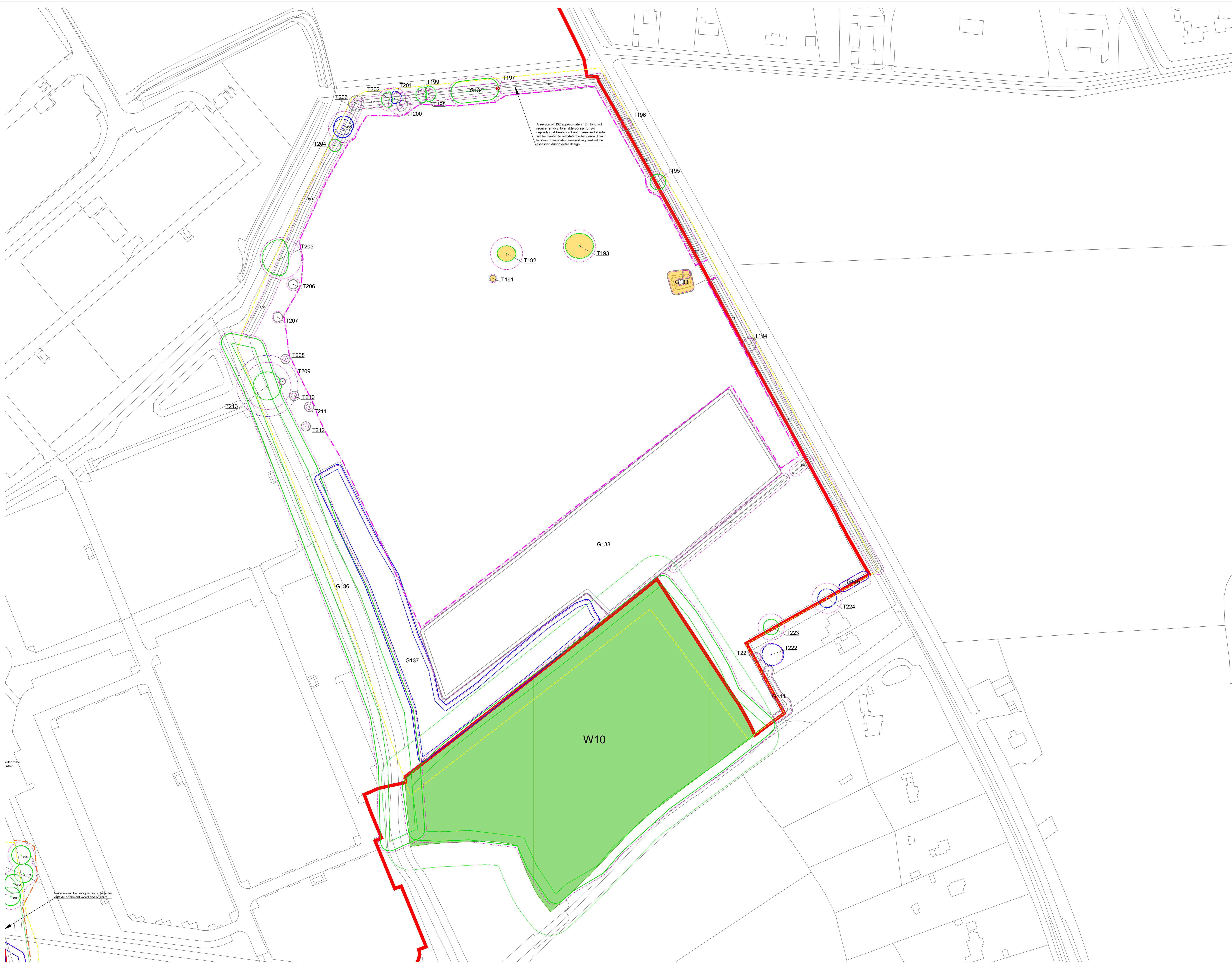

- Key**
- Site boundary
  - Survey boundary
  - Tree with numbered reference. Canopy extent and coloured BSS537:2012 tree quality category as shown below.
    - = Tree details estimate (inaccessible tree)
    - = Tree in off site location
  - Tree group plotted with individual stem locations and numbered reference. Canopy extent coloured to match BSS537:2012 tree quality category as shown below and dashed line to show indicative stem line.
  - Hedge with numbered reference. Canopy extent and coloured BSS537:2012 tree quality category as shown below and dashed line to show hedge centreline.
  - Woodland with numbered reference. Canopy extent coloured to match BSS537:2012 tree quality category as shown below and dashed line to show indicative tree line.
- BSS 537:2012 Tree Quality Categories - Table 1**
- Category A - High quality
  - Category B - Moderate quality
  - Category C - Low quality
  - Category U - Unstable for retention
- Direction of first significant branch
  - Root protection area (RPA). Calculated in accordance with Section 4.6.2 - BSS537:2012.
  - Veteran tree buffer (15 x stem Ø) (as per standing advice produced by Forestry England and Natural England).
  - Tree protected by Tree Preservation Order. Bracketted number relates to the TPO reference.
  - Designated Ancient Woodland (as per Natural England ancient woodland inventory, via open data publication).
  - Ancient Woodland tree buffer (15m offset) (as per standing advice produced by Forestry England and Natural England).
  - Projected tree loss required for construction of the Project (worst case scenario).
  - Indicative Scheme Layout
  - Indicative temporary protective fence line in accordance with Section 6.2 - BSS537:2012. See below for example barriers.
  - Indicative secondary protective H15 Mesh fence line in accordance with Section 6.2 - BSS537:2012. See below for example barriers.
  - Indicative vegetation protective fence line; Design and location to be agreed by local council during detail design.

**NOTES:**

- Refer to ES Appendix 6.10.1: Tree Survey Report and Arboricultural
- Some assessments for further details.
- The information is for guidance only and does not constitute a full arboricultural report.
- The information is for guidance only and does not constitute a full arboricultural report.
- Some trees may be lost during design, demolition and construction.
- Some trees may be lost during design, demolition and construction.

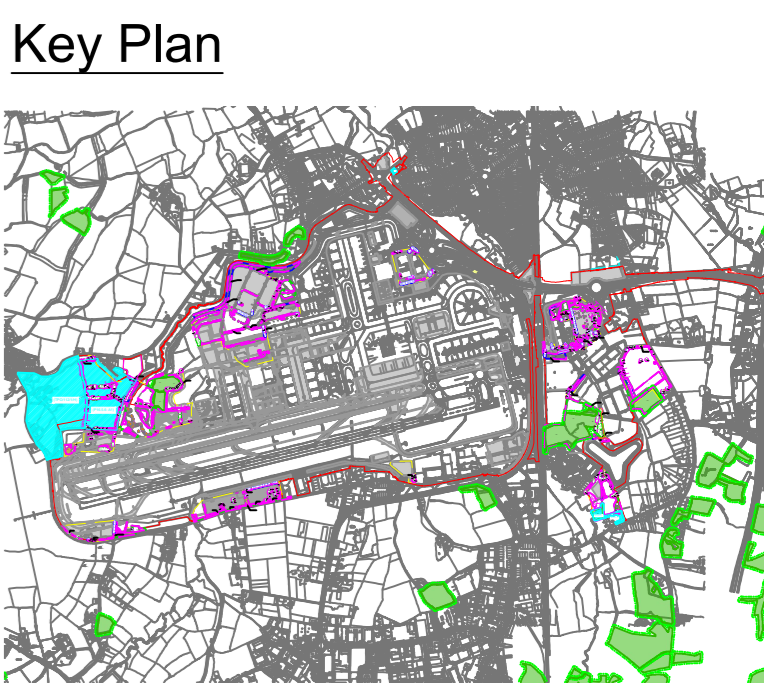
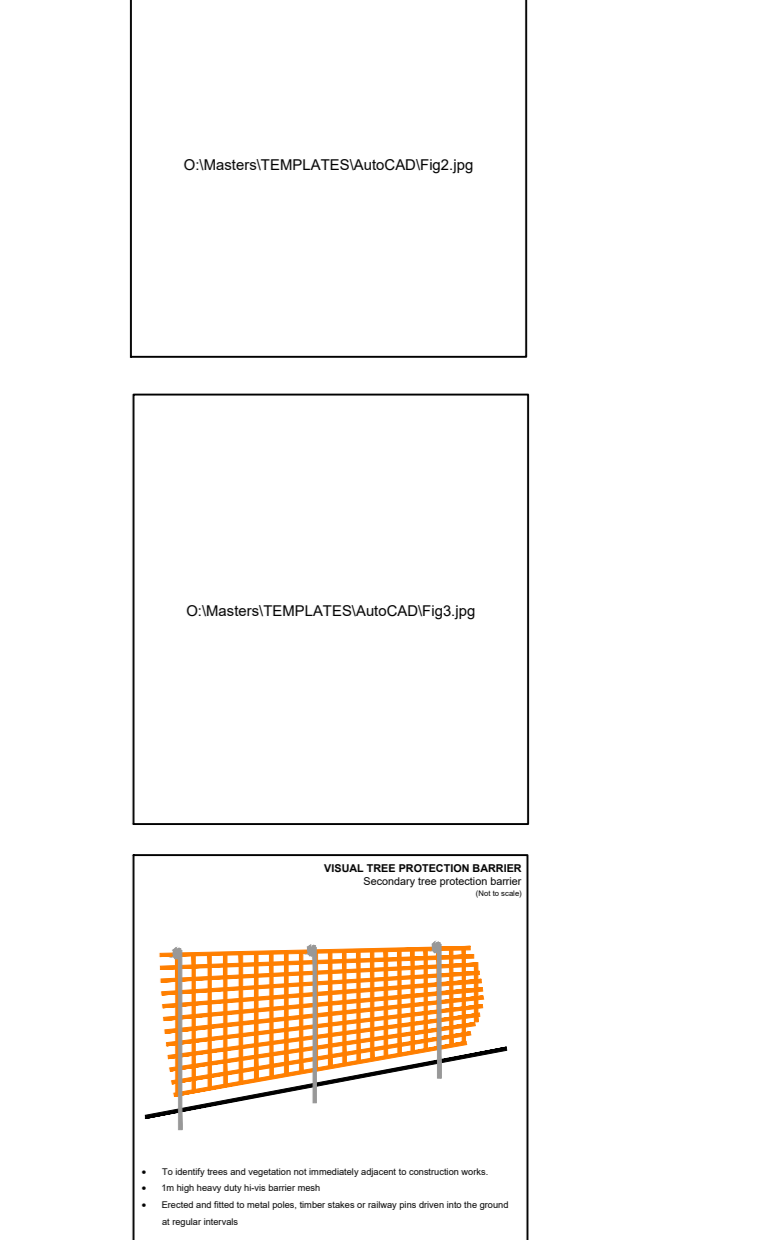

**DOCUMENT**

**Environmental Statement**

DRAWING TITLE  
**Airport Preliminary Tree Removal & Protection Plans**  
 Appendix 5.3.2 Annex 6  
 Sheet 8 of 13

DATE  
**June 2024**

ORIENTATION N	DRAWING NO. 757	REVISION For ES Issue
	DRAWN BY RC	PM / CHECKED BY DC

SCALE @ A0  
 0m 25m 50m

Reproduced from Ordnance Survey map with the permission of Ordnance Survey on behalf of the controller of Her Majesty's Stationery Office © Crown Copyright (2023). License number 0100031673, 10001998, 100048492.  
 © Copyright 2023 Gatwick Airport Limited. No part of this drawing is to be reproduced without prior permission of Gatwick Airport Limited.

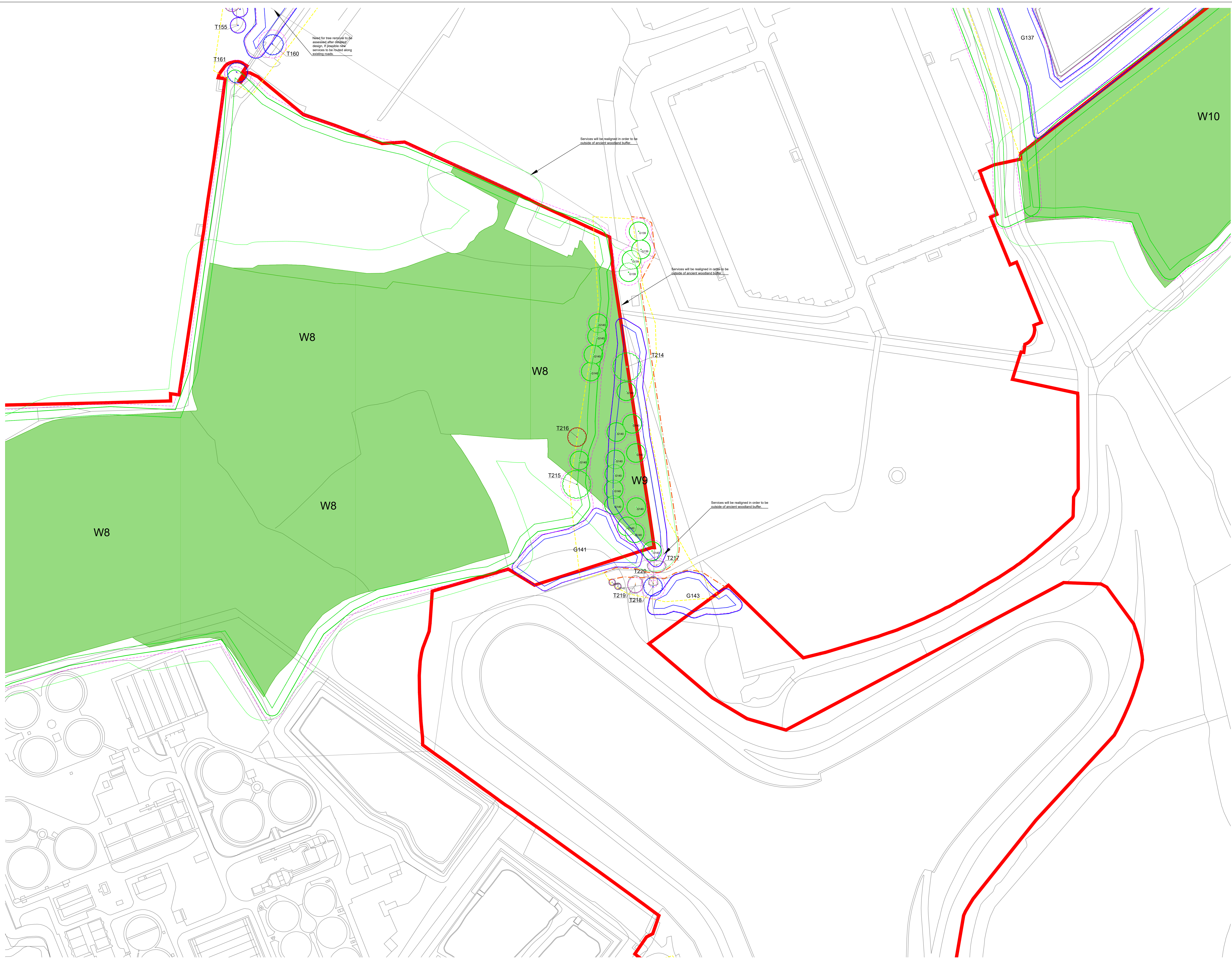

### Key

- Site boundary
- Survey boundary
- Tree with numbered reference  
Canopy extent and colour to match BS5837:2012 tree quality category as shown below  
  - = Tree details estimate (non-visible tree)
  - \* = Tree in off site location
- Tree group plotted with individual stem locations and numbered reference. Canopy extent colour to match BS5837:2012 tree quality category as shown below and dashed line to show indicative stem line.
- Hedge with numbered reference  
Canopy extent and colour to match BS5837:2012 tree quality category as shown below and dashed line to show hedge centreline.
- Woodland with numbered reference  
Canopy extent colour to match BS5837:2012 tree quality category as shown below and dashed line to show indicative tree line.

BS 5837:2012 Tree Quality Categories - Table 1

- Category A - High quality
- Category B - Moderate quality
- Category C - Low quality
- Category U - Unsuitable for retention

- Direction of first significant branch
- Road protection area (RPA)  
Calculated in accordance with Section 4.6 - BS5837:2012
- Veteran tree buffer (15 x stem Ø)  
(as per standing advice produced by Forestry England and Natural England)
- Tree protected by Tree Preservation Order. Bracketted number relates to the TPO reference.
- Designated Ancient Woodland  
(as per Natural England ancient woodland inventory, via open data publication)
- Ancient Woodland tree buffer (15m offset)  
(as per standing advice produced by Forestry England and Natural England)
- Projected tree loss required for construction of the Project (best case scenario)
- Indicative Scheme Layout
- Indicative temporary protective fence line in accordance with Section 6.2 - BS5837:2012. See below for sample barriers.
- Indicative secondary protective H/Vs Mesh fence in accordance with Section 6.2 - BS5837:2012. See below for sample barriers.
- Indicative vegetation protective fence line; Design and location to be agreed by local council during detail design.

- NOTES:**
- Refer to ES Appendix 6.10: Tree Survey Report and Arboricultural
  - Investigations for further details.
  - As a full arboricultural report.
  - The work will be carried out in accordance with the recommendations set out in BS 5837:2012 - "Trees in Relation to Design, Demolition and Construction".
  - Some trees are protected by Tree Preservation Orders and are listed in the

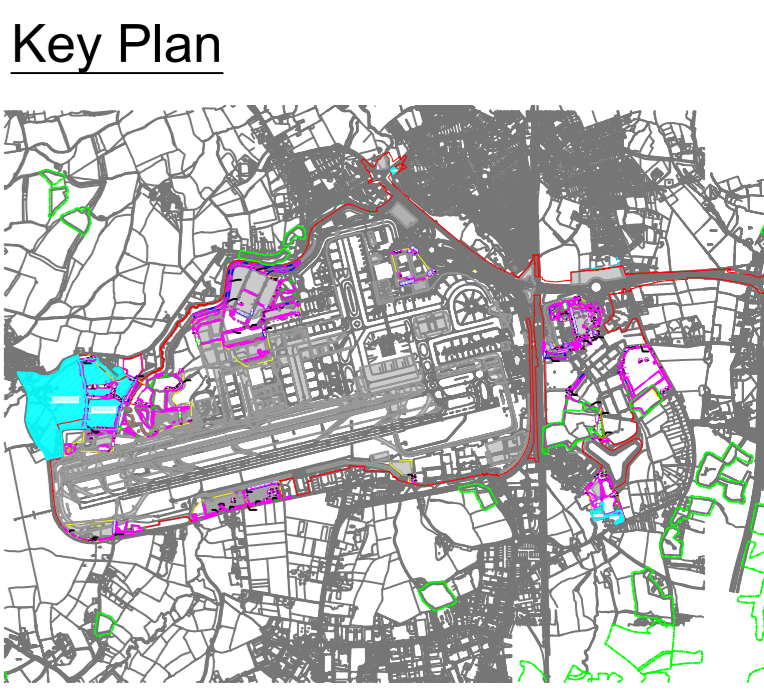

**Environmental Statement**

DRAWING TITLE  
**Airport Preliminary Tree Removal & Protection Plans**  
Appendix 5.3.2 Annex 6  
Sheet 9 of 13

DATE: **June 2024**

ORIENTATION N	DRAWING NO. 758	REVISION For ES Issue
	DRAWN BY RC	PM / CHECKED BY DC

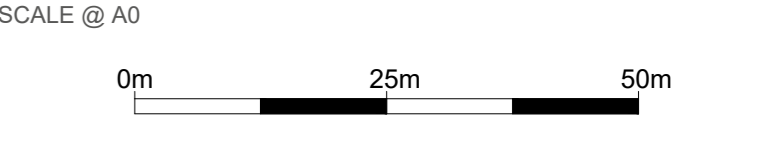

Reproduced from Ordnance Survey map with the permission of Ordnance Survey on behalf of the controller of Her Majesty's Stationery Office © Crown Copyright (2023). License number 0100031673, 10001998, 100048492.  
© Copyright 2023 Gatwick Airport Limited. No part of this drawing is to be reproduced without prior permission of Gatwick Airport Limited.

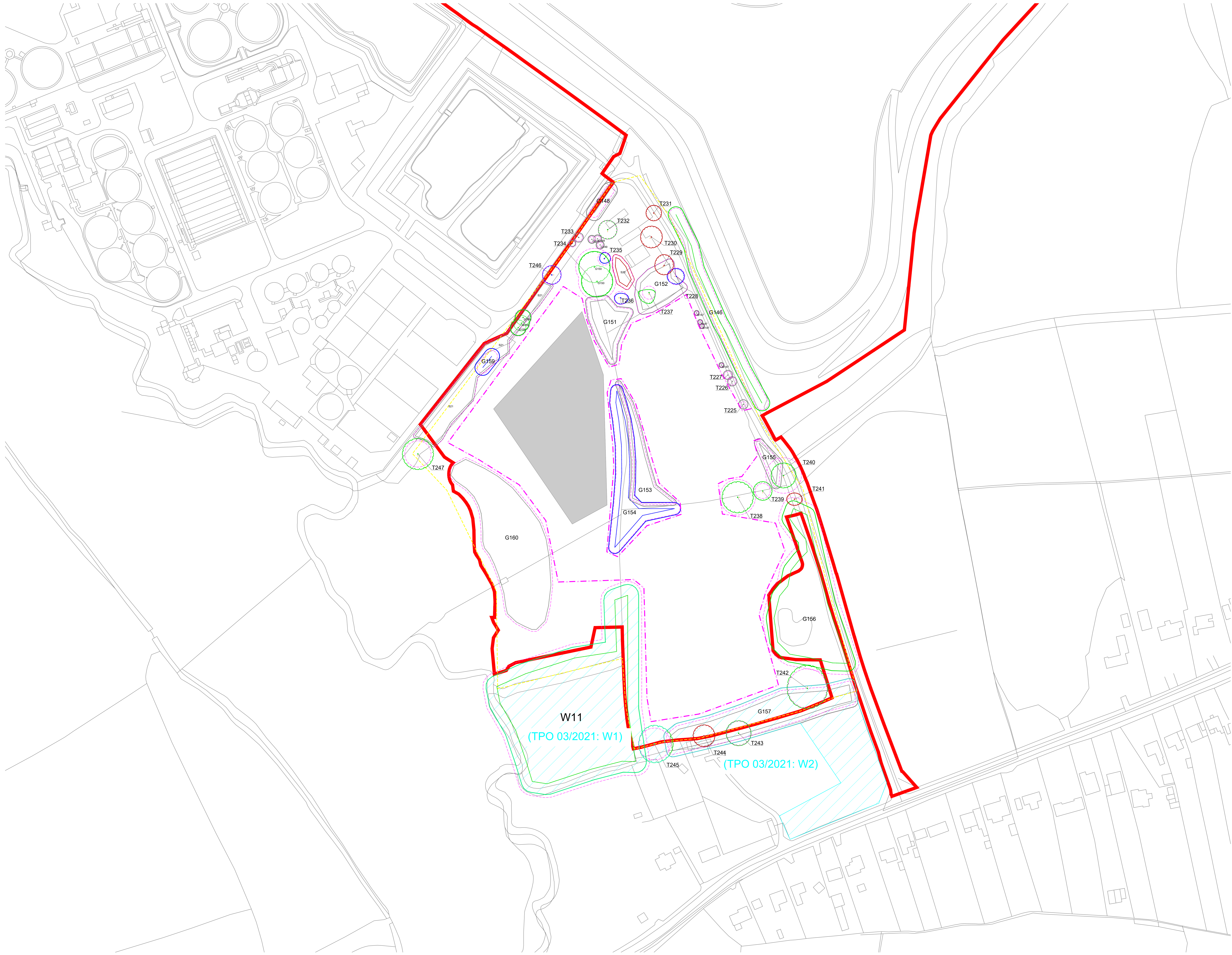

- Key**
- Site boundary
  - Survey boundary
  - Tree with numbered reference. Canopy extent and colour BSS837:2012 tree quality category as shown below.
    - = Tree details estimate (accessible tree)
    - = Tree in off site location
  - Tree group plotted with individual stem locations and numbered reference. Canopy extent colour to match BSS837:2012 tree quality category as shown below
  - Tree or vegetation group with numbered reference. Canopy extent colour to match BSS837:2012 tree quality category as shown below and dashed line to show indicative stem line.
  - Hedge with numbered reference. Canopy extent and colour BSS837:2012 tree quality category as shown below and dashed line to show hedge centreline.
  - Woodland with numbered reference. Canopy extent colour to match BSS837:2012 tree quality category as shown below and dashed line to show indicative tree line.
- BSS837:2012 Tree Quality Categories - Table 1**
- Category A - High quality
  - Category B - Moderate quality
  - Category C - Low quality
  - Category U - Unsuitable for retention
- Direction of first significant branch
  - Root protection area (RPA). Calculated in accordance with Section 4.6.1 of BS5837:2012
  - Veteran tree buffer (15 x stem ID) (as per standing advice produced by Forestry England and Natural England)
  - Tree protected by Tree Preservation Order. Bracketted number relates to the TPO reference.
  - Designated Ancient Woodland (as per Natural England ancient woodland inventory, via open data publication)
  - Ancient Woodland tree buffer (15m offset) (as per standing advice produced by Forestry England and Natural England)
  - Projected tree loss required for construction of the Project (worst case scenario)
  - Indicative Scheme Layout
  - Indicative temporary protective fence line in accordance with Section 6.2 - BS5837:2012. See below for example barriers.
  - Indicative secondary protective H/Vs Mesh fence line in accordance with Section 6.2 - BS5837:2012. See below for example barriers.
  - Indicative vegetation protective fence line; Design and location to be agreed by local council during detail design.

**NOTES:**

- Refer to ES Appendix 6.10.1: Tree Survey Report and Arboricultural Survey on behalf of the controller of Her Majesty's Stationery Office
- Some areas are a visual restriction from the ground and is not intended as a full arboricultural inspection.
- The plan is in accordance with recommendations set out in BS 5837:2012 - "Trees in Relation to Design, Demolition and Construction".
- Some trees are not shown in this plan and are located to the west of the site.

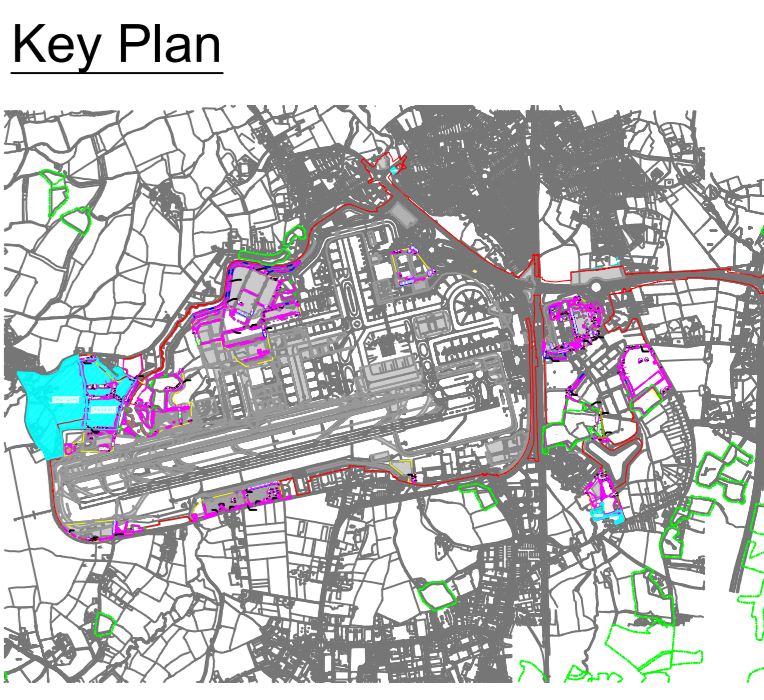
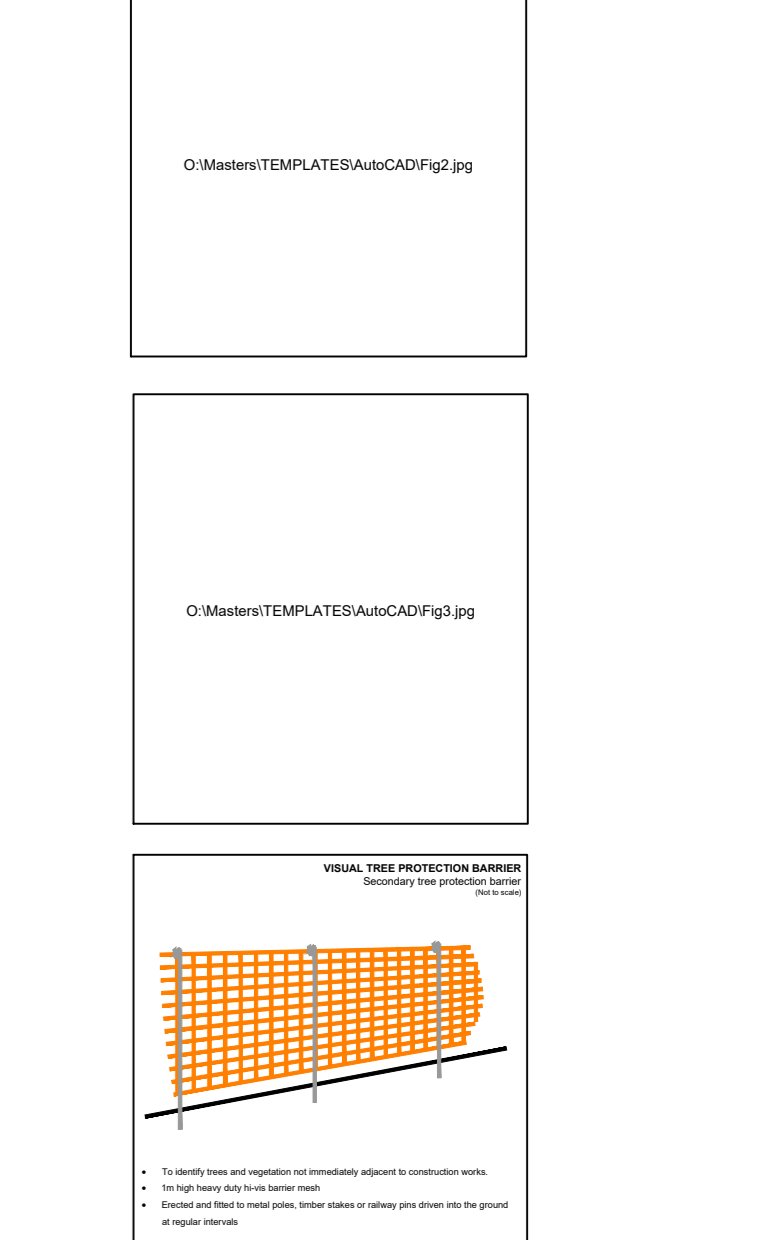

**Environmental Statement**

**DRAWING TITLE**  
 Airport Preliminary Tree Removal & Protection Plans  
 Appendix 5.3.2 Annex 6  
 Sheet 10 of 13

**DATE**  
June 2024

<b>ORIENTATION</b> N	<b>DRAWING NO.</b> 759	<b>REVISION</b> For ES Issue
	<b>DRAWN BY</b> RC	<b>PM / CHECKED BY</b> DC

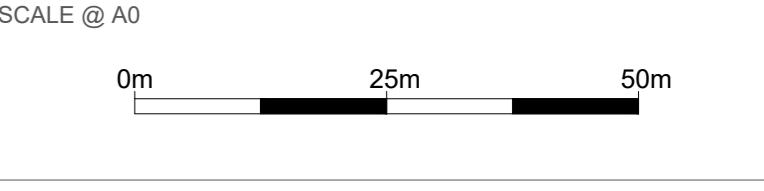

Reproduced from Ordnance Survey map with the permission of Ordnance Survey on behalf of the controller of Her Majesty's Stationery Office © Crown Copyright (2023). License number 0100031673, 100048492.  
 © Copyright 2023 Gatwick Airport Limited. No part of this drawing is to be reproduced without prior permission of Gatwick Airport Limited.